



Nagra Streamer



USER MANUAL

Safety warnings

- Read this manual carefully before operating the Nagra Streamer.
- Should you have any questions on how to setup or use your Streamer, please contact your Nagra dealer.
- Audio Technology Switzerland SA declines any responsibility in the event of an accident caused by the non-observance of these instructions or any other form of user negligence.
- The Streamer is CLASS I equipment. It is essential that its power supply is connected to a MAINS socket outlet with a protective earthing connection.
- The Streamer must not be exposed to liquids and no objects filled with liquids, such as vases, should be placed on the machine.
- Never open your Streamer because of a risk of electric shock and burns. Only Nagra dealers & qualified technicians are authorized to do it for maintenance and specific settings.

Warranty

Audio Technology Switzerland SA certifies that this device has been inspected and tested before leaving the factory.

We guarantee our products against all manufacturing defects, for a period of three years for the Streamer, beginning from the date of delivery to the customer (validated by the serial number on the device casing and the invoice from an official Nagra dealer). This warranty is only valid for the original purchaser of new equipment.

This limited warranty covers the repair and replacement of defective parts, excluding any other remedy. The absence or alteration of a serial number invalidates the warranty.

We decline any responsibility for damages resulting directly or indirectly from the use of our products and from the use of any components or spare parts other than those designated as original/approved parts by Audio Technology Switzerland SA.

As we constantly strive to improve our products, we reserve the right to modify them or change their specifications without notice.

Congratulations

Congratulations, you have just purchased one of the best Streamers ever made!

The Streamer was created by an engineering team with more than 70 years of experience designing world-class products for the professional audio, national security and military businesses.

Since its inception in 1951, Nagra has built products that continue to earn a reputation for delivering ultimate sonic performance. Numerous awards have been bestowed upon Nagra for its technical innovation, excellence in design and flawless construction including two Oscars® and two Emmys®.

The professional and Hi-Fi ranges are both designed by our Research and Development department. Nagra has launched a Hi-Fi range to allow the wider public to benefit from technical advances that are often the sole privilege of professionals.

This technology exists in the service of music, your music. We wish you great moments of listening pleasure with your Streamer.

Thank you for your trust.

Package contents

The package of your Streamer includes the following parts:

- One (1) Streamer device chassis
- One (1) user manual
- One (1) power supply and power cord*
- One (1) N-Link fiber optics cable

Please contact your Nagra dealer should anything be missing.

* Depending on your country, the power cord features either a US, European or Swiss plug.

INSTALLATION OF Streamer

Choosing a location

The Streamer is designed exclusively for indoor use in a moderate climate.

Connection the power supply

You can use the provided power supply.

To improve the overall performance of your Streamer and your set-up, you can purchase a Nagra Lemo to DC cable and connect the Streamer to either:

- Nagra ACPS III
- Nagra MPS
- Nagra Classic PSU

The Classic PSU will provide the best performance.

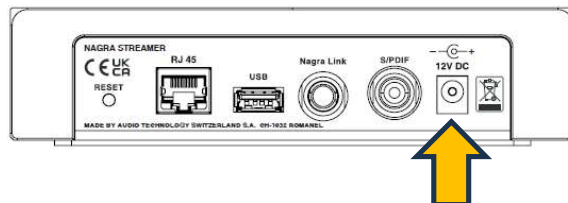

12 v DC connector position

Connection to your network

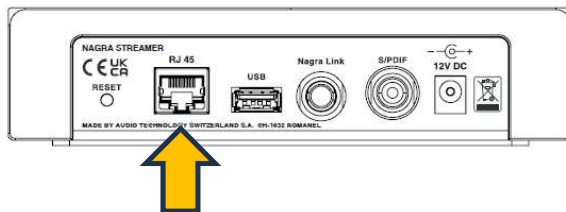

Connect the Streamer to your network with an Ethernet RJ45 cable.

The Streamer will be controlled via Wifi. Your Wifi should be provided by the same access point as the ethernet connection (like a typical home router would do).

Connection to a Nagra D/A

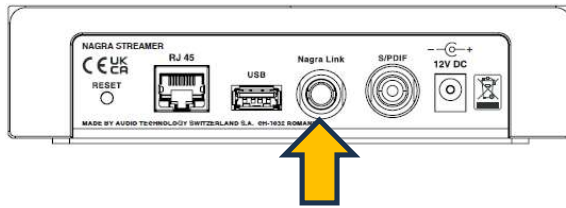

Use the N-Link output to connect your Nagra D/A. N-Link is available on the HD DAC X, the TUBE DAC and the Classic DAC II.

Original HD DAC can be upgraded to “TUBE DAC” level to feature the N-Link. Other Nagra D/A or third party D/A will connect via the SPDIF output through the RCA connector.

Please note the N-Link will provide a better sound quality as it can play up to DSD 4x (or DSD 256) and it provides an optical isolation between the Streamer and the D/A, meaning it isolates from the computer network as well.

Connection to a non Nagra D/A

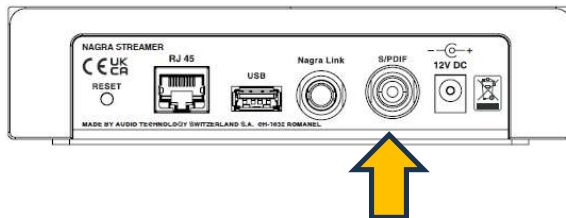

Use SPDIF output to connect to your D/A converter.

Through the SPDIF connection, formats up to 192 kHz 24 bits and DSD 64 (or DSD) via DoP (DSD over PCM) can be played. You need to configure your source to play these formats. Higher resolution formats will not be compatible.

Playing files from a USB device

You can play files from a USB key or a USB hard drive. You should connect it here:

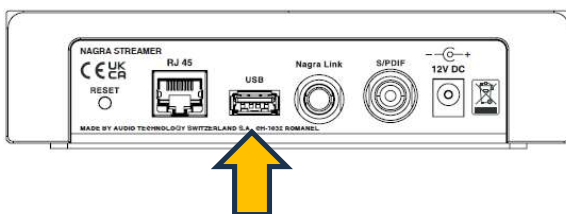

TIDAL Settings

Within TIDAL App you can detect the Streamer and select it as the output device to stream your music.

Click on the icon

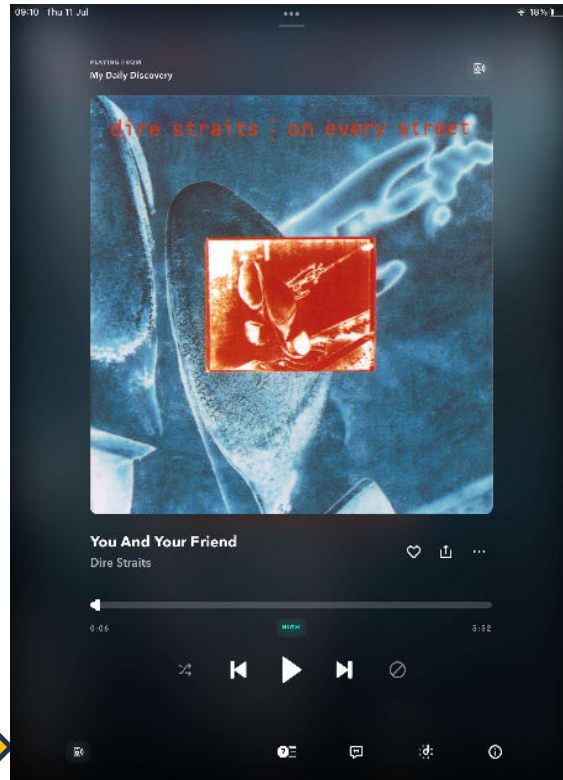

Select Nagra Streamer

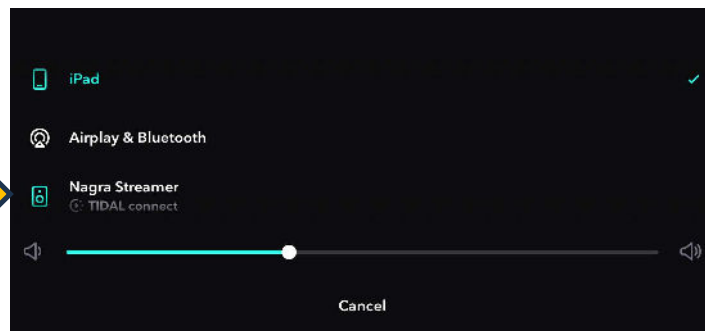

Spotify settings

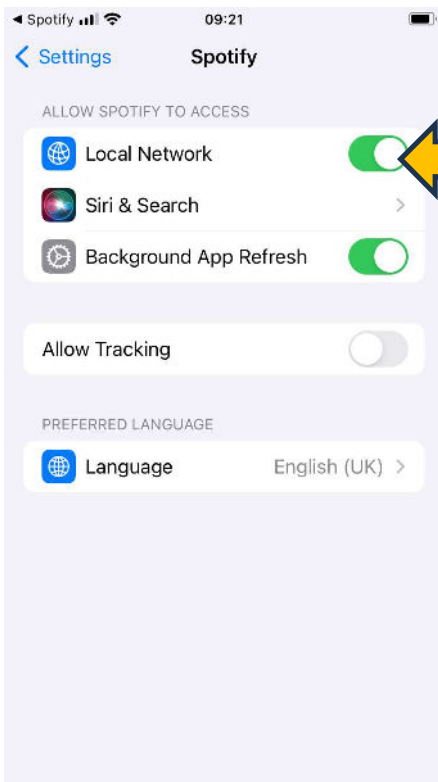
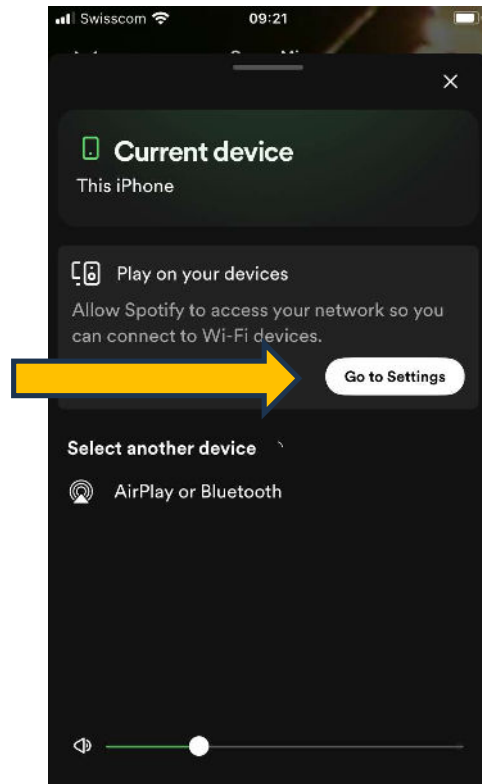
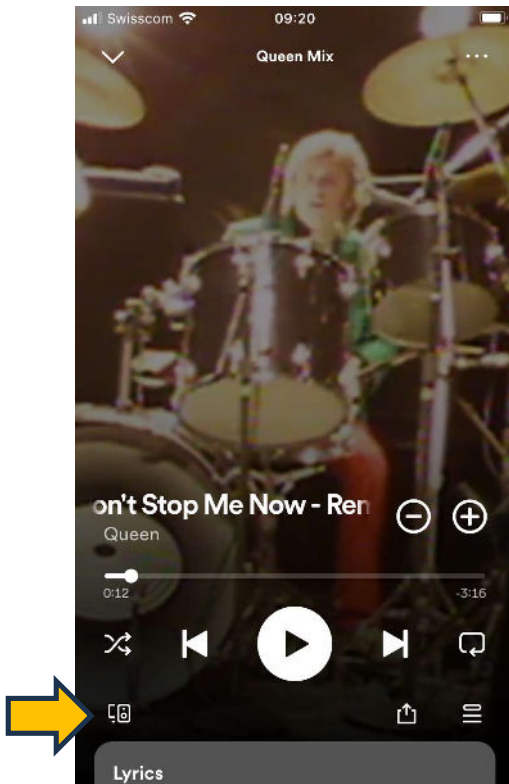

Allow Spotify to access your Local Network

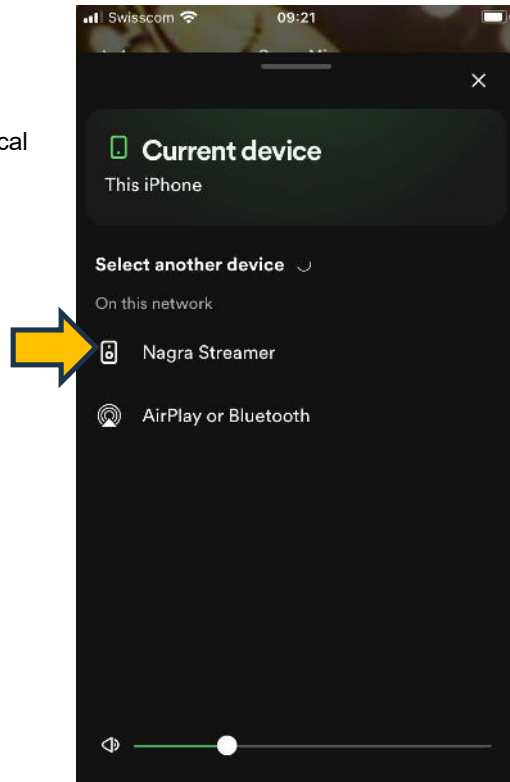

You are now playing through the Nagra Streamer

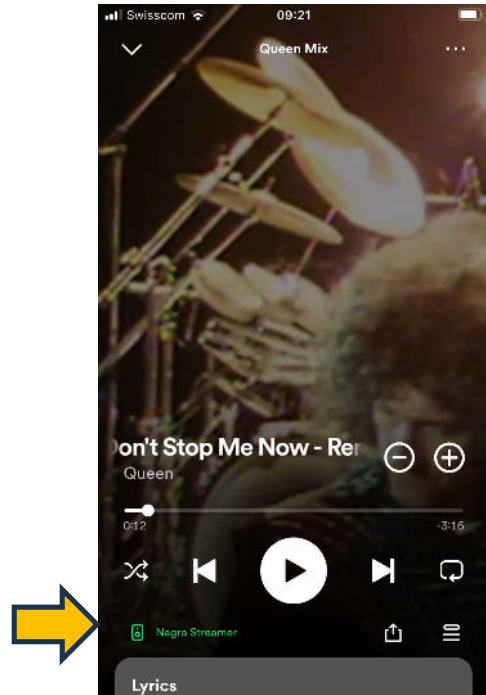

Streamer with Airplay and Airplay 2

Select your Apple Player

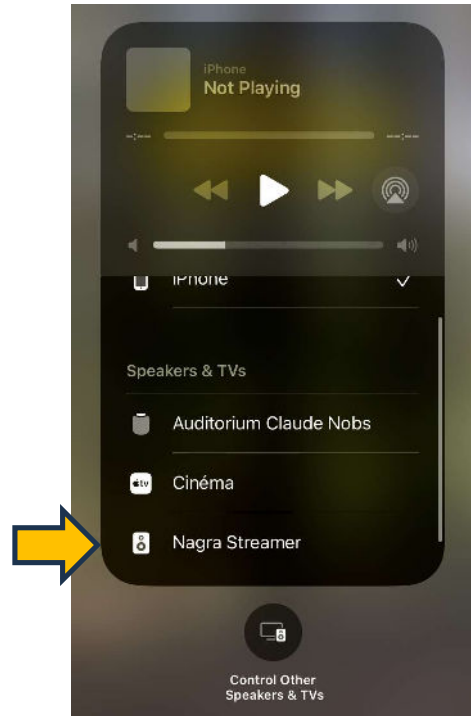
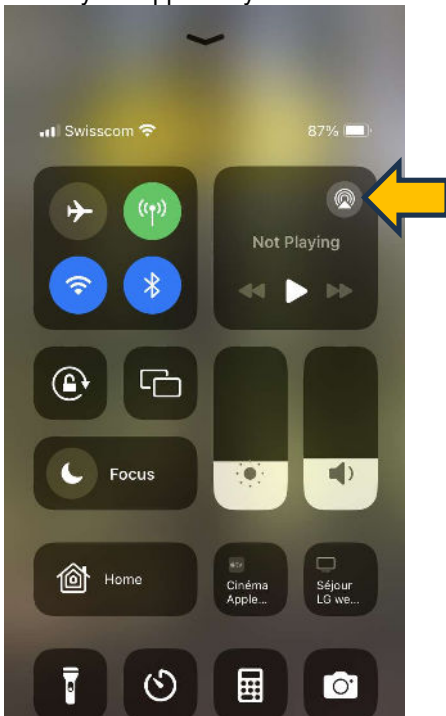

Getting the most of your Nagra Streamer

To get the most of your Streamer, you should use the following apps. They will allow you to play from major music providers as well as local files from a USB stick or hard drive.

Visit your Apple Store or Google Play Store and download the **Mconnect CONTROL** app. This app is free of charge and available for phone or tablets.

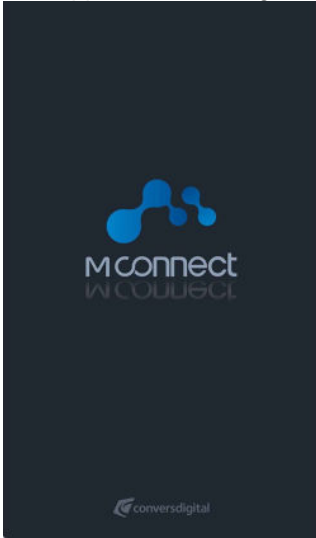

Please note that this app is provided by a third party called Conversdigital.

The **Mconnect CONTROL** app is designed to work in portrait mode and is compatible with phones and tablets.

If you want to use a tablet exclusively, you should download the **Mconnect CONTROL HD**.

Operating your Streamer

Once the application is installed

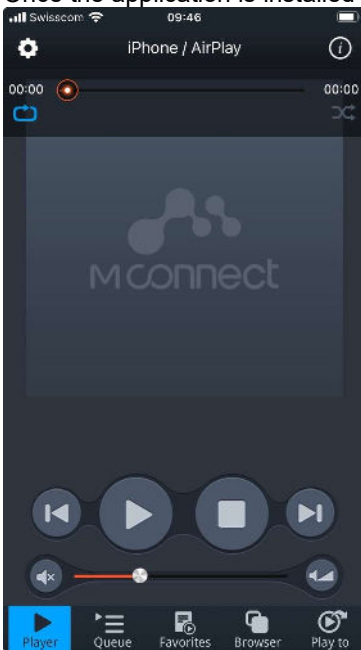

Select
Play to



Select the
Nagra Streamer

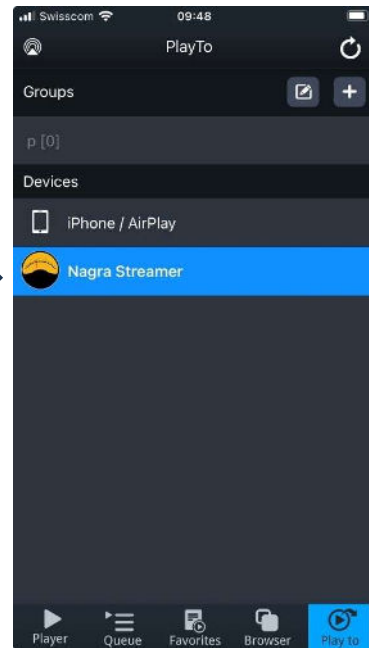

A lot of music options

The Nagra Streamer is packed with features that you can access through the **M Connect** app

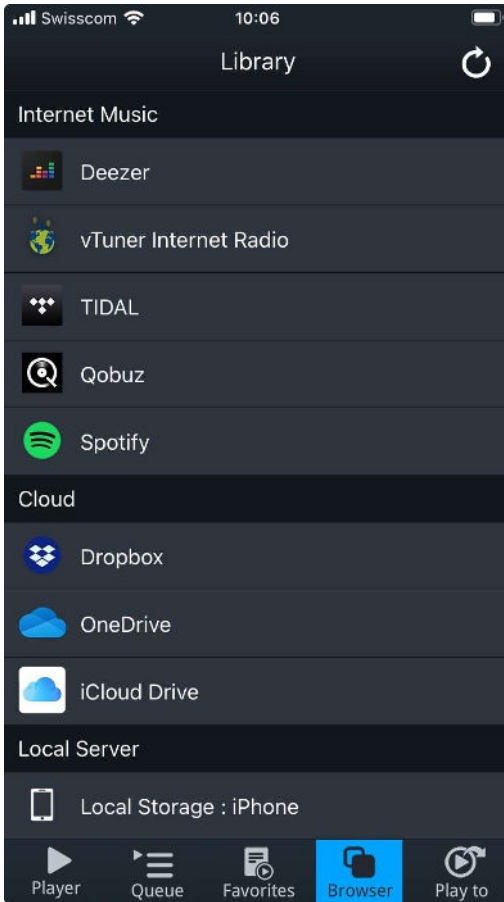

You can access your Deezer account

vTuner Internet Radio offers thousands of live radio stations from around the world

You can also access your music stored on
Dropbox
OneDrive
iCloud Drive

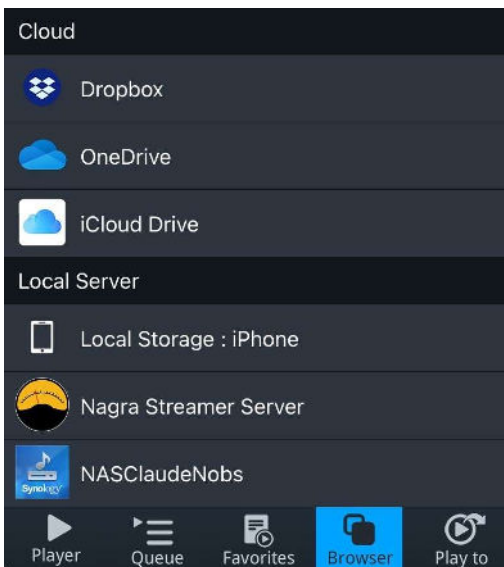

Select this to access music on your device

This is the USB Stick or HDD connected to your Streamer

This is the storage (NAS) available from your network

Playing files from a USB memory or hard drive

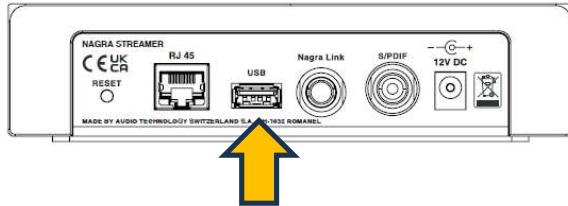

Insert your USB device here

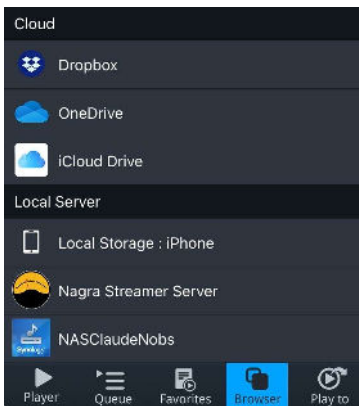

Select the Nagra Streamer Server

Select the folder you want to play from

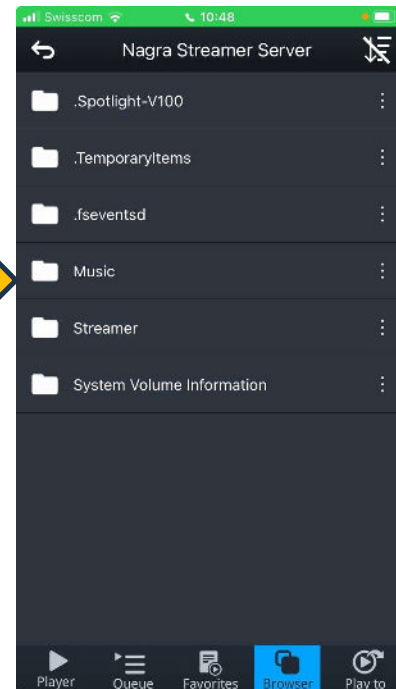

Playing from local files, either from the USB or on the network allows you to listen to high resolution up to DSD 256 (or DSD 4x). This is the best solution to play at the best quality. Please note that DSD 256 needs a N-Link connection to your Nagra D/A converter.

Qobuz via M Connect

You can access your QOBUZ account through M Connect

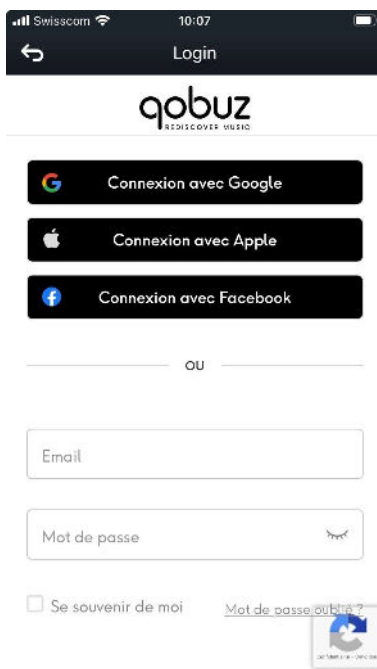
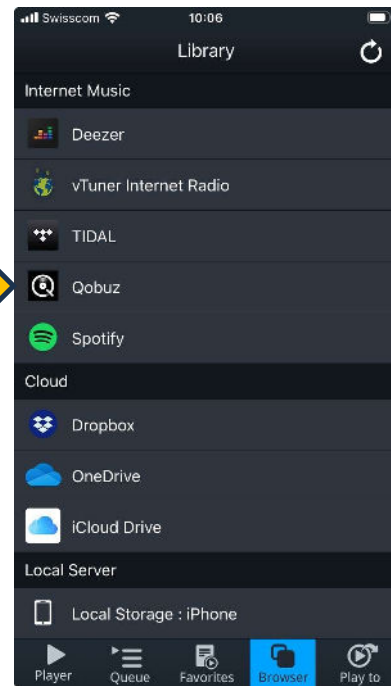
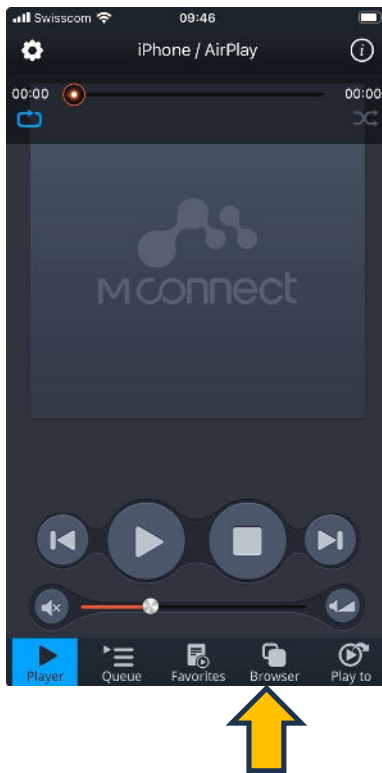

Provide qobuz with your login information

Multi-room with M-Connect

CREATING A MULTI-ROOM GROUP

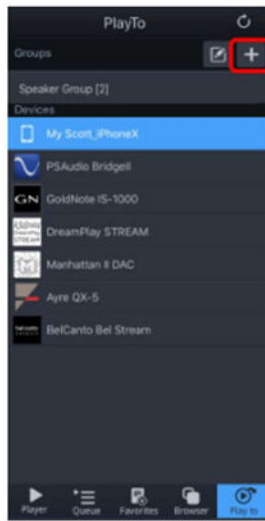

Create new Group of Speakers for Multi-room Playback:

- 1) Touch "+" button at Groups bar in "Play to" screen.
- 2) You will see the "Add Group" window to enter the Group Name.
- 3) After enter into the Group Name, and then select the Group.
- 4) Touch "+" button at the Group screen.
- 5) Select devices to include in the Group at device list window.

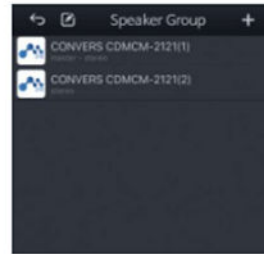
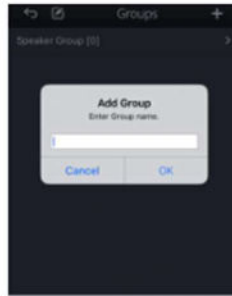

PLAY MUSIC TO THE MULTI-ROOM GROUP

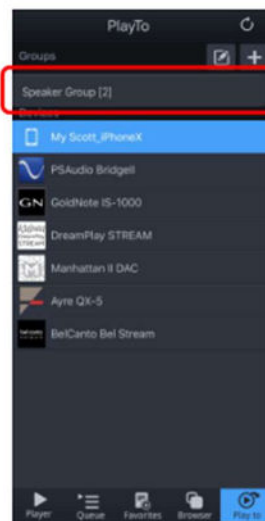

Select the Group as the playback device at "Play to" screen.

Select music to play, then music will be played by all the devices in the Group at the same time with synchronization.

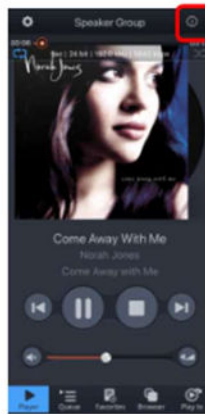

By touching the "Device Info" button, you can see the devices in the Group and control the volume for each device.

TECHNICAL SPECIFICATIONS

Network connections	Ethernet RJ45 USB hard drive or memory stick	
Output	N-Link for compatible Nagra D/A – up to DSD 256 (DSD 4x) SPDIF for other D/A -up to 192 kHz, DSD 64 (DSD 1x) with DOP	
Powering	12 V DC, about 0.7 A consumption	
Power consumption	10 W	May increase with a USB HDD
Operating temperature	+15 °C to +35 °C +59 °F to +95 °F	Moderate climate
Operating environment	Indoor only	IP30
Overall dimensions LxWxH	W x D = 185 x 166 x 41 mm	7.2 x 6.5 x 1.6 inches
Weight (net)	1.9 Kg	4.1 lb

Specifications may change without notice



Disposal of old electrical & electronic equipment (Applicable in the European Union and other European countries with separate collection systems).

This symbol on the product or on its packaging indicates that it should be handed over to the applicable collection point for the recycling of electrical and electronic equipment. By ensuring this product is disposed of correctly, you will help prevent potential negative consequences for the environment and human health. The recycling of materials will help to conserve natural resources. For more detailed information about recycling of this product, please contact your local authority, your household waste disposal service or the shop where you purchased the product.

Applicable to the following devices:
Streamer and all the package contents